

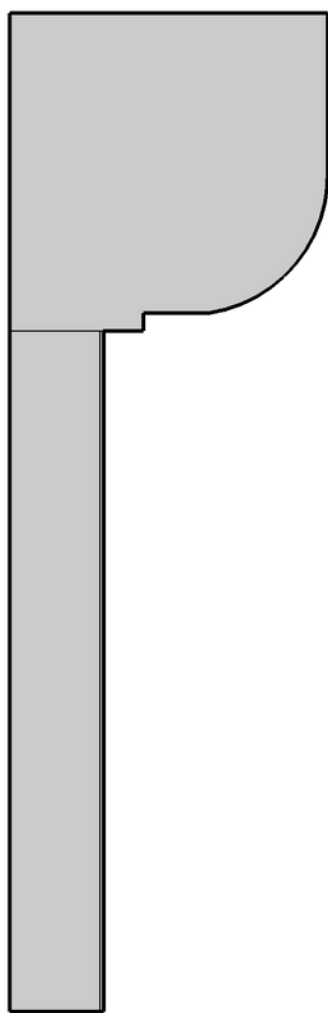

Motorized Roll Screen Products, 5-1/2" and 7" Housings  
Up to 30' in Width

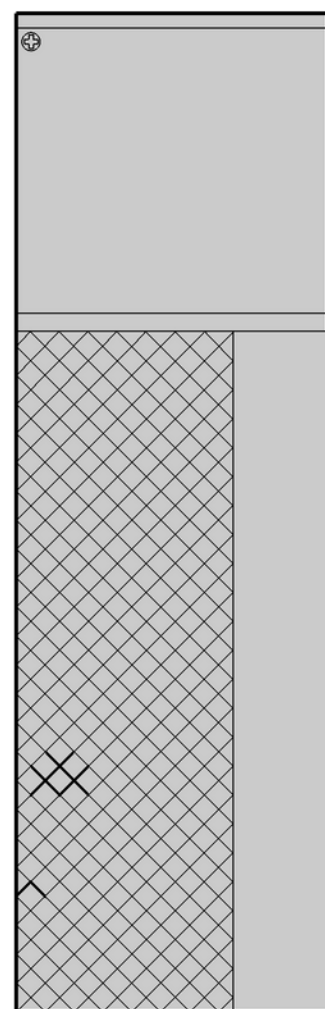

Side/Profile View



Front View

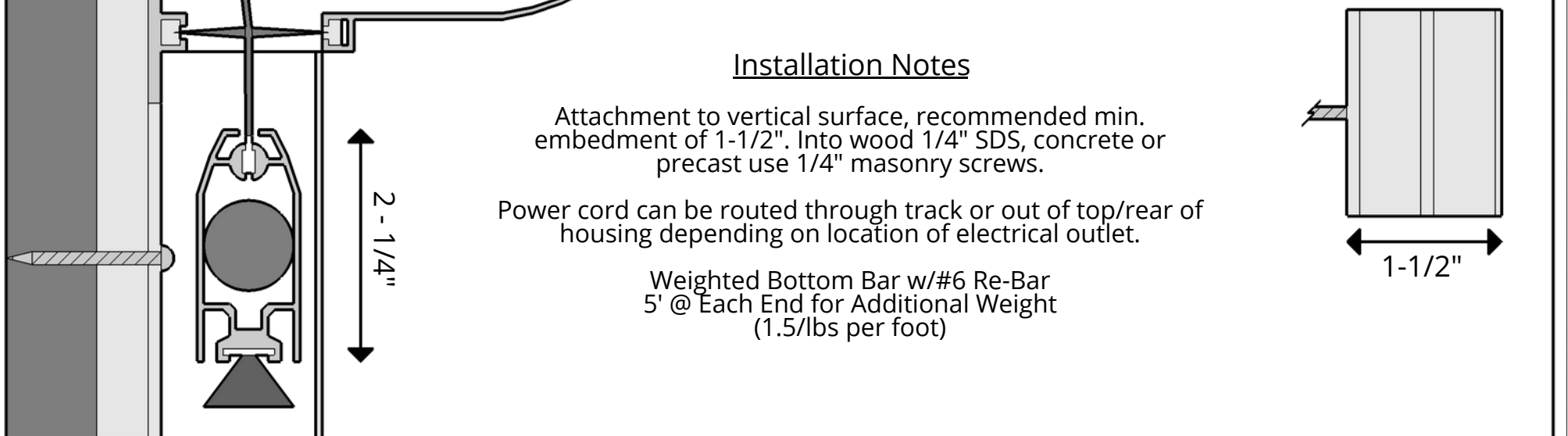
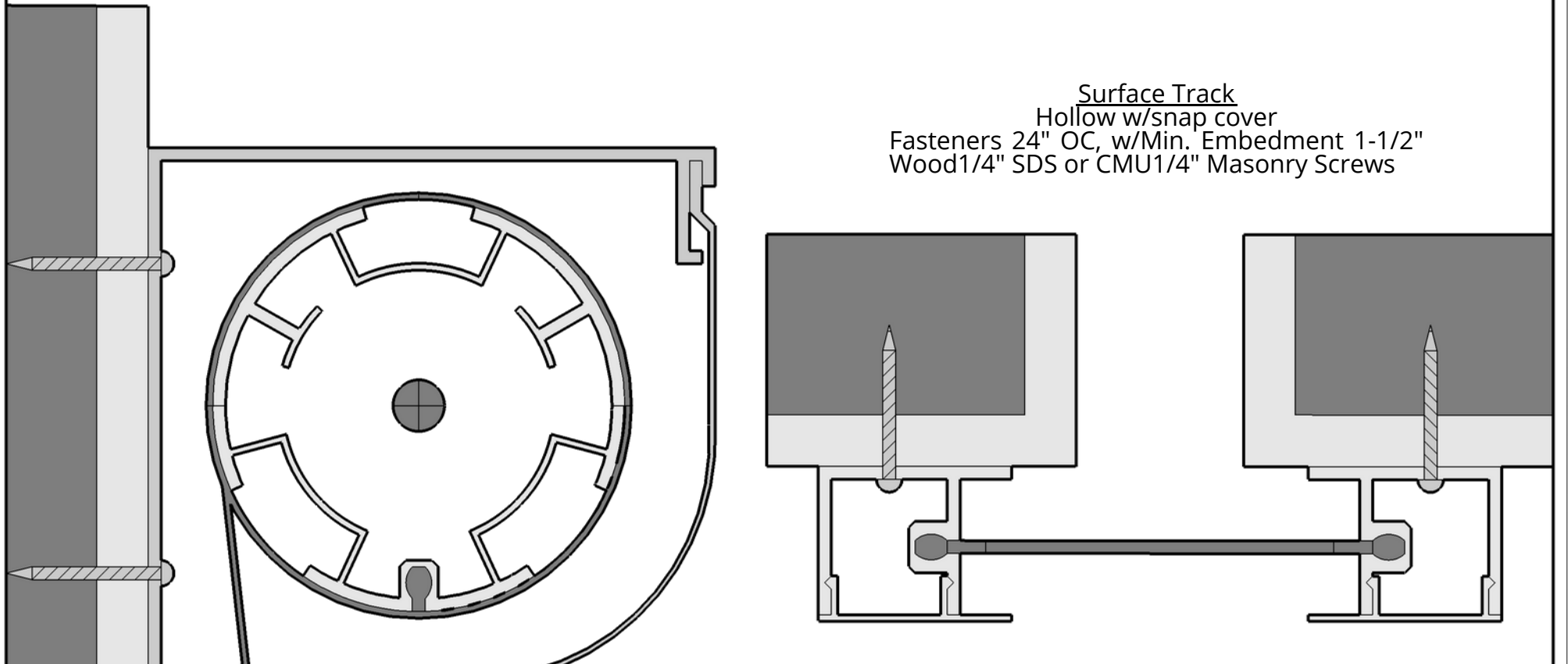
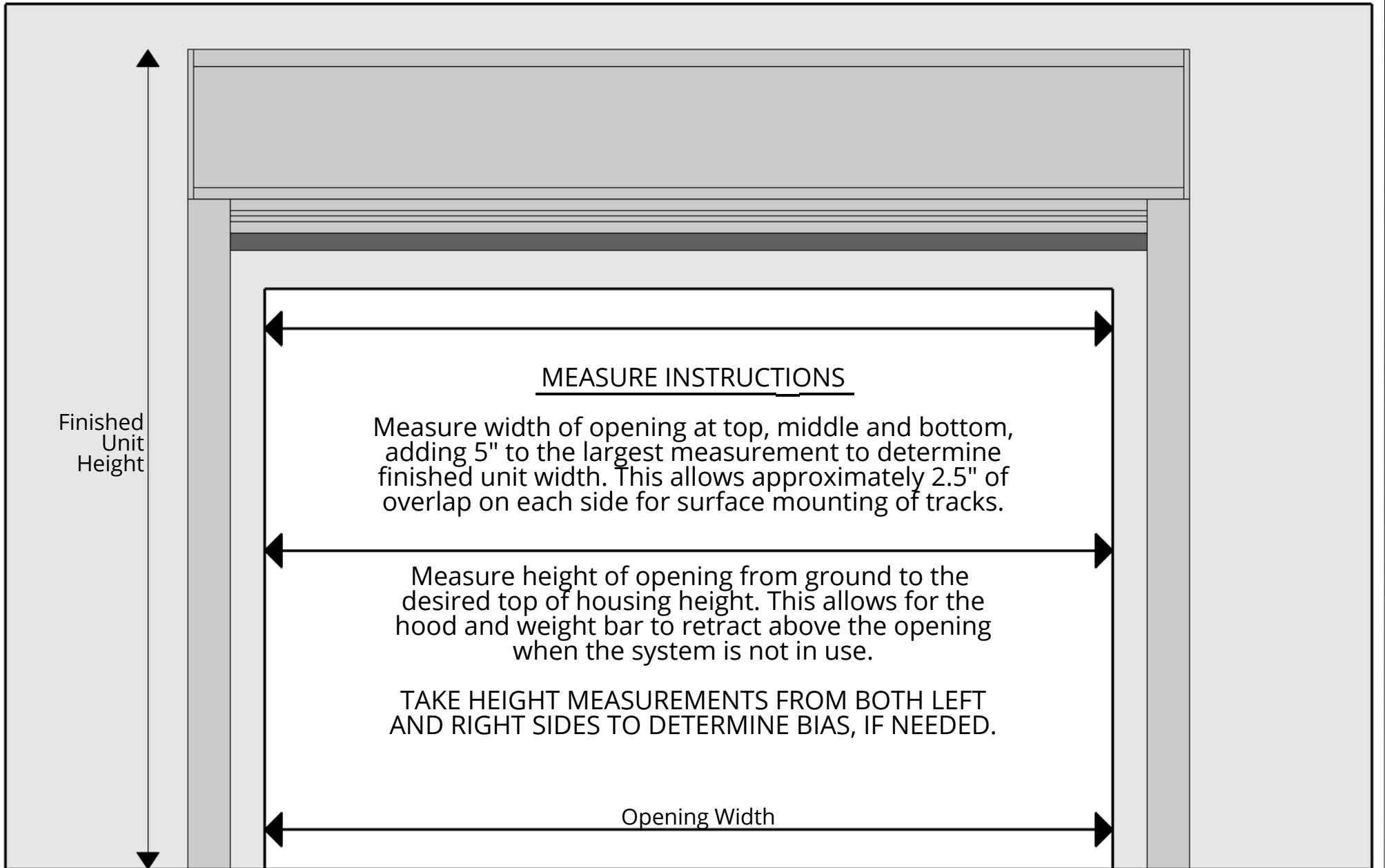

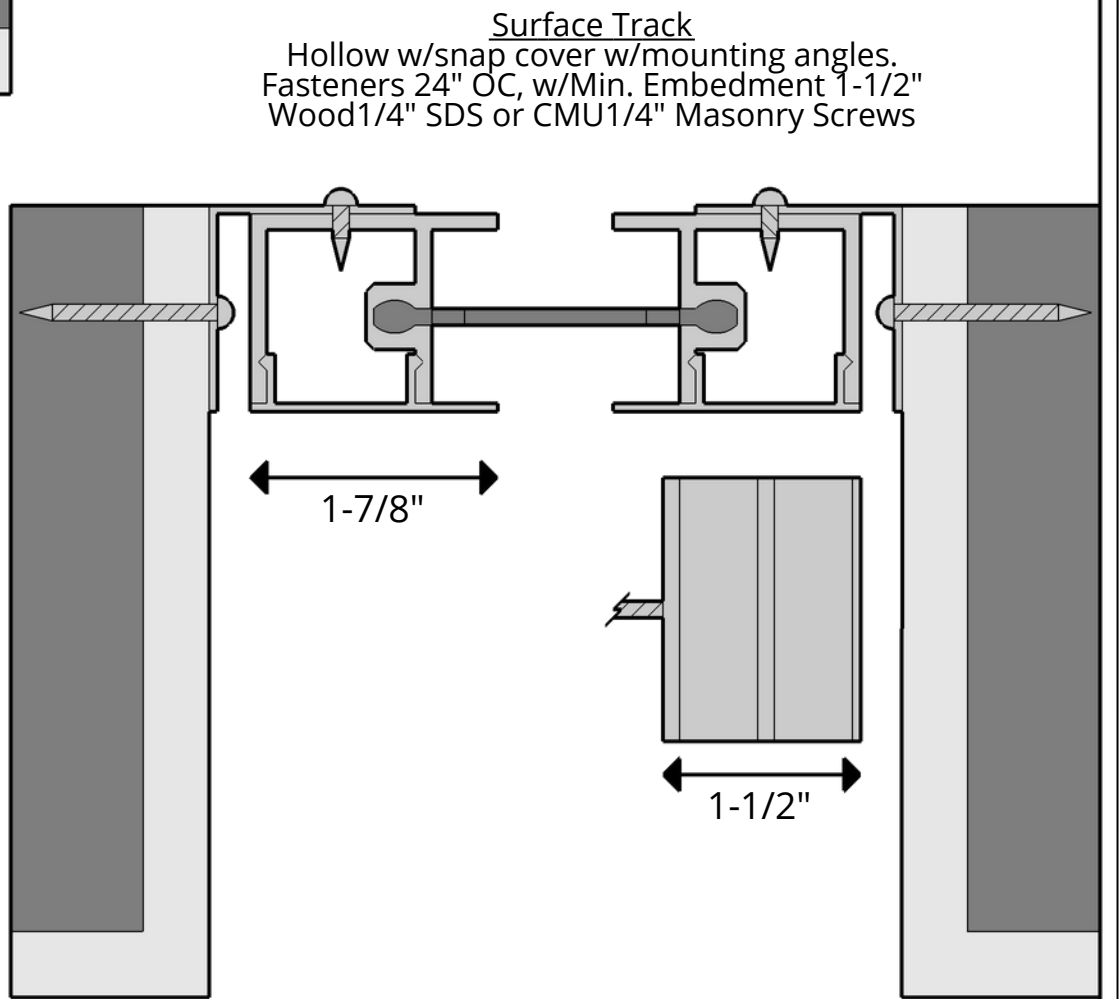
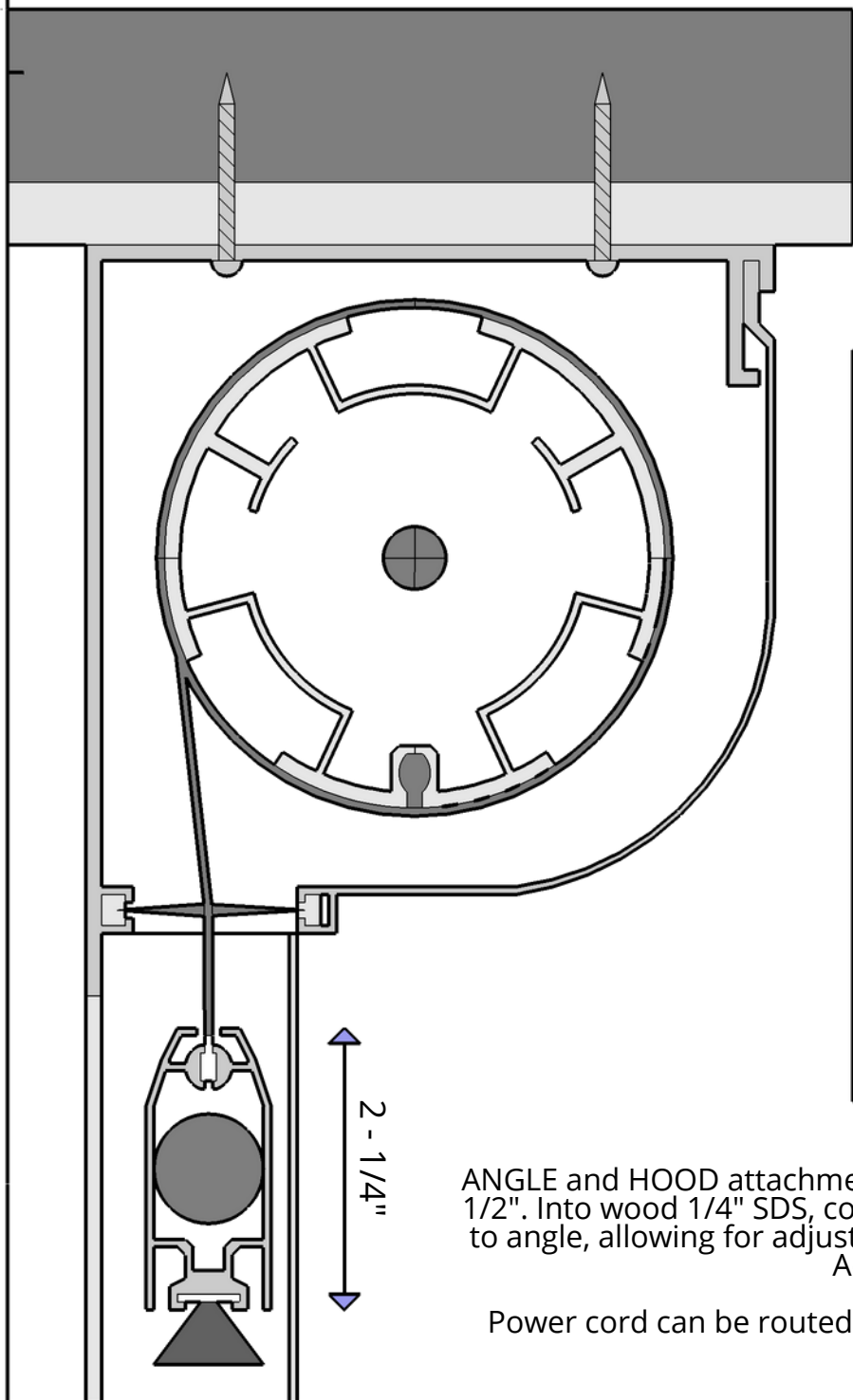
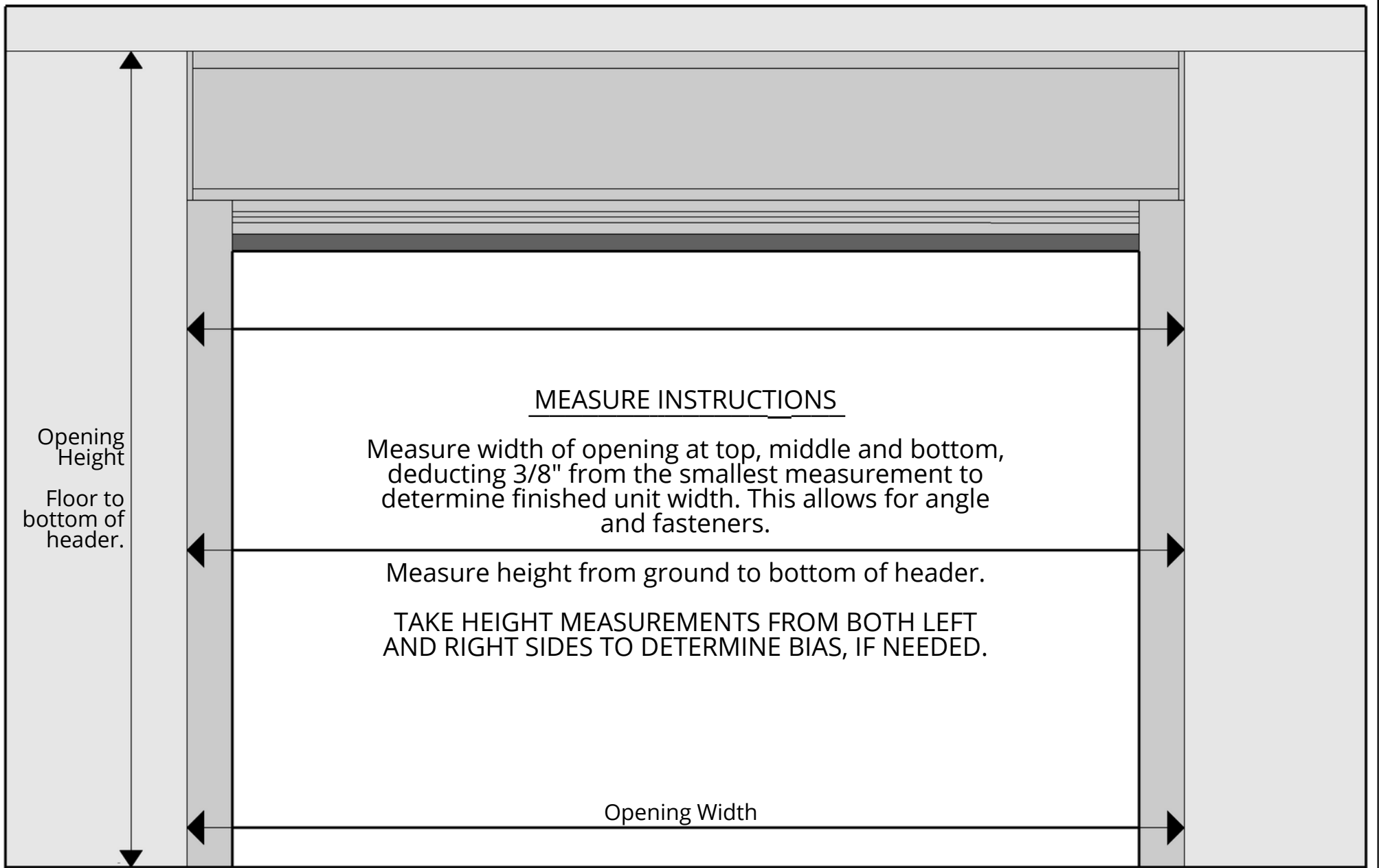

**Installation Notes**

ANGLE and HOOD attachment to vertical surface, recommended min. embedment of 1-1/2". Into wood 1/4" SDS, concrete or precast use 1/4" masonry screws. Tracks attached to angle, allowing for adjustment. Weighted Bottom Bar w/#6 Re-Bar 5' @ Each End for Additional Weight (1.5/lbs per foot)

Power cord can be routed through track or out of top/rear of housing depending on location of electrical outlet.

REVISIONS	
MM/DD/YY	REMARKS
12/29/2014	Original Date
1	of Drawing
2	---/---/---
3	---/---/---
4	---/---/---
5	---/---/---

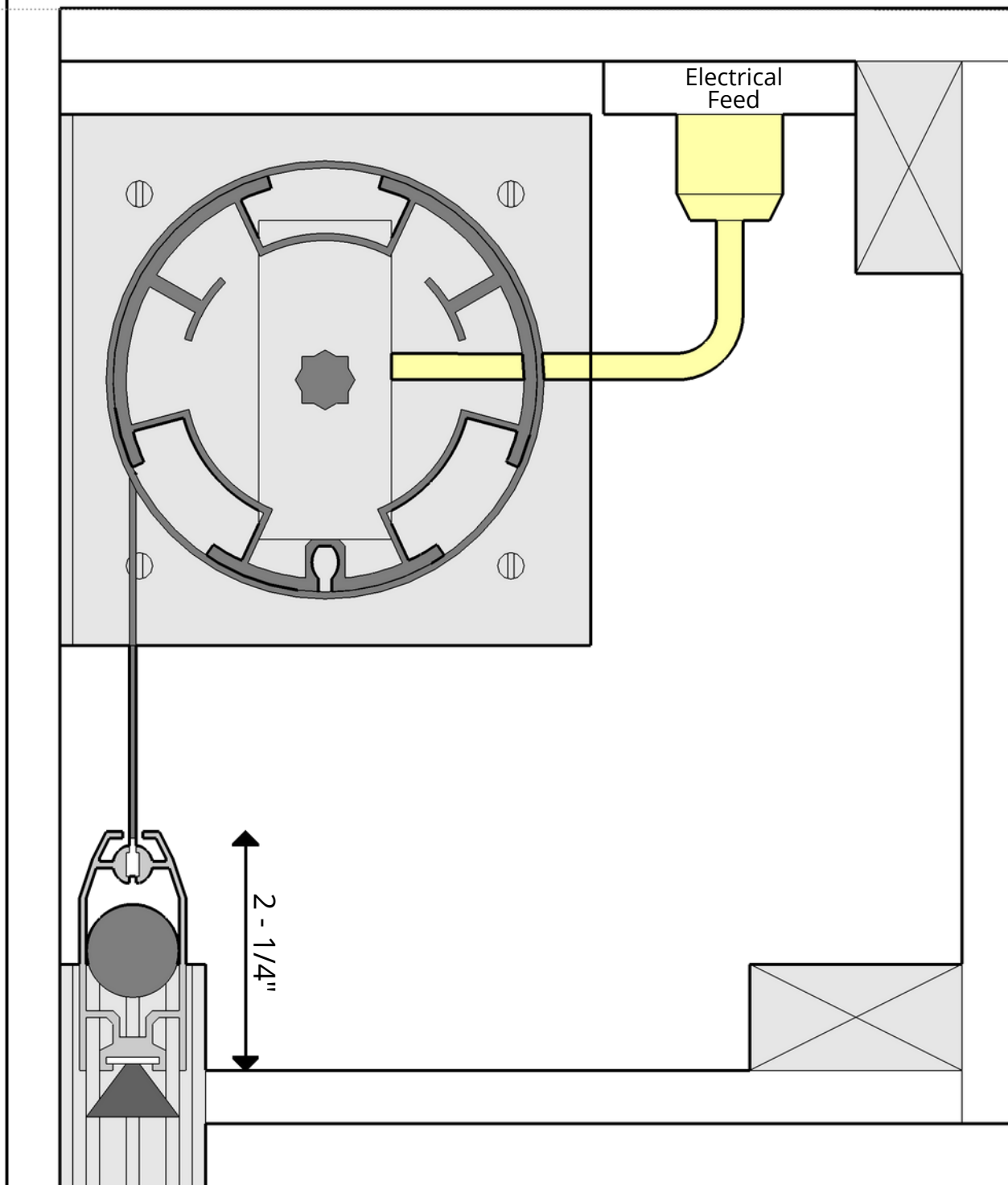
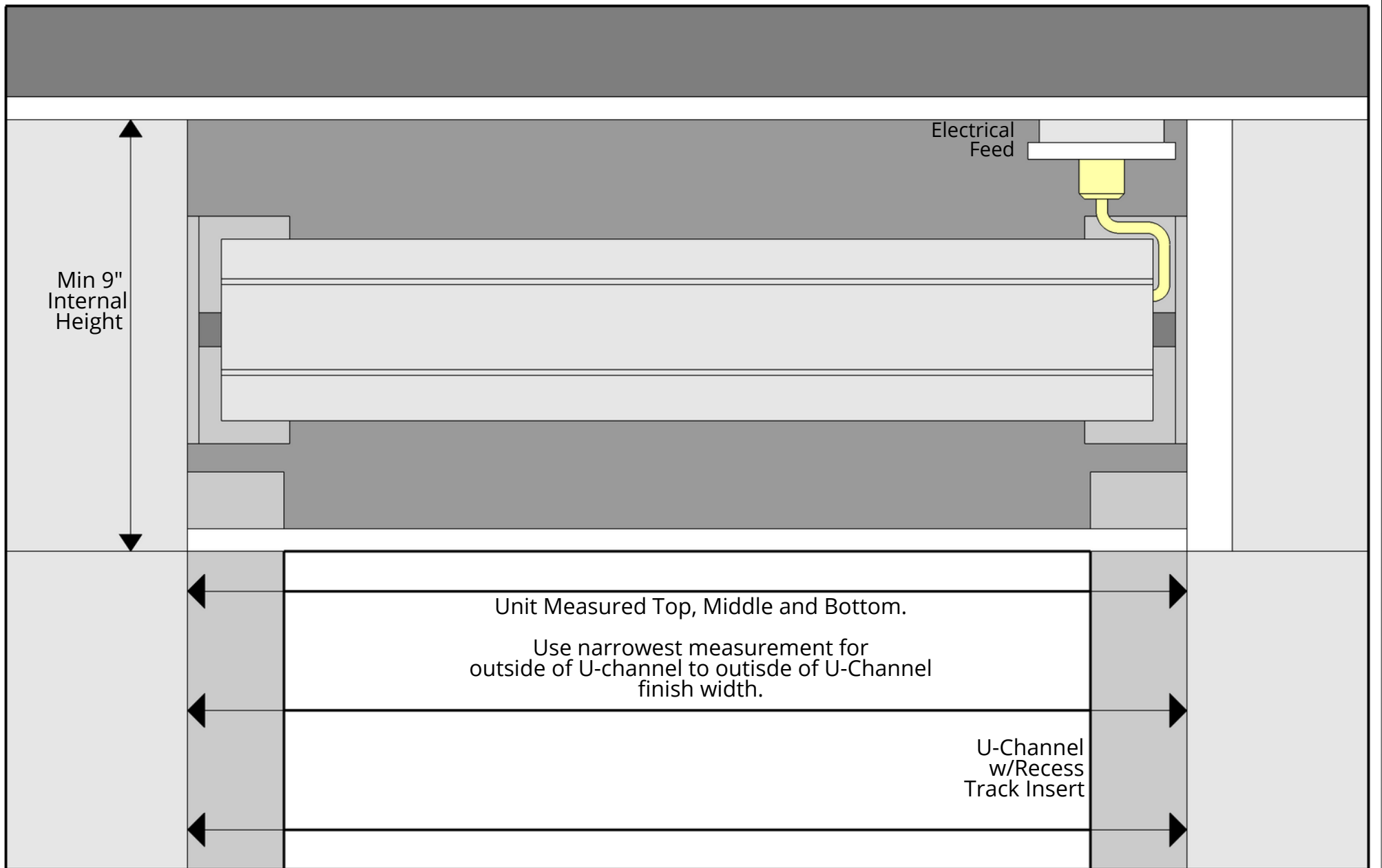

**Installation Notes**  
 5"x5" Recess Brackets to receive roll-tube.  
 NOTE: 7"x7" Brackets typically if width of tube is greater than 20'.  
 Min. Vertical Clearance of 9" to conceal unit & weight bar and sweep.  
 Removeable access panels located at front or bottom of recess cavity.  
 Power feed required at one of of recess cavity, ensuring that receptical/box is forward inside of cavity. Make sure receptacle box allows for screen operation and for removal and installation of roll tube.  
 Weighted Bottom Bar w/#6 Re-Bar 5' @ Each End for Additional Weight (1.5/lbs per foot)

**Recess Track**  
 U-Channel w/track insert and adj. clips. Fasteners 24" OC, Min. Embedment 1-1/2" Wood 1/4" SDS or CMU 1/4" Masonry Screws

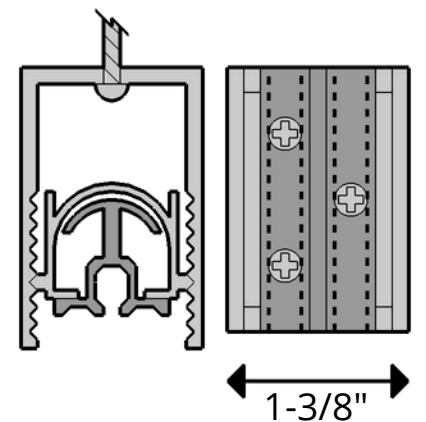

# Recessed Roll Screen Installation (IAHR)



REVISIONS	
MM/DD/YY	REMARKS
12/29/2014	Original Date
1	of Drawing
2	---/---/---
3	---/---/---
4	---/---/---
5	---/---/---